



Nano SPY Reference

Standard measuring instrument
for the Nano SPY range sensors



Non contractual photo

Presentation

A reference device designed to perform calibrations of connected loggers in the Nano SPY range, the Nano SPY Reference recorder measures and records temperature with high precision and has a 3m cryogenic probe.

Its metrological specificities allow it to be perfectly adapted to the monitoring of equipment with very limited temperature ranges.

Technical features

Interface	Status LED and On/Off touch sensitive button
Measurement range	-196°C to +200°C
Accuracy	± 0.15°C from 0 to +40 °C ± 0.20°C from -30°C to 0 and from +40 to +130°C ± 0.30°C from +130 to +200°C ± 0.50°C out this range ± 0.60°C to -196°C
Communication frequency	2,4 GHz (802.15.4)
Memory	10 000 data points
Sensor	External Class A PT 100 - stainless steel Ø2,9x25mm 3m cable lenght
Operating conditions	-20°C to +50°C
Resolution	0.01
Measuring and transmission period	1 mn
Internal memory recording period	Adjustable from 1 mn to 24 hrs
Response time σ_{90}	~ 2mn
Protection	IP65
Case	Polycarbonate – Food contact
Power supply	Lithium 3,6v battery - Replaceable
Battery life	6 years
Dimensions and weight	63 x 42 x 25 mm / ~ 60 g
Fixation	Fixing eyelets and integrated magnets
Supplied with	Brown identification ring User manual can be download on www.jri-corp.com
Compliance	CE, ROHS, FCC, ETS 300-328
Standard calibration points	+15°C ; +45°C

Benefits

- **Easy-to-use**
The sensor is ready to use and has operating and alarm lights



- **Excellent measurement accuracy**



Fixing eyelets



Replaceable battery and non disconnectable probe

PART NRS
12521 E : Nano SPY Référence
12521 X : Nano SPY Référence without battery

19 373 EN 01 04

Accessories



Protective shell
Part nr. 12715

The protective shell is used to protect all Nano SPY mini-data loggers from shocks. It is supplied with a double-sided adhesive to be glued to all surfaces and an anti-theft screw for the Nano SPY. It can also be screwed (screws not supplied).

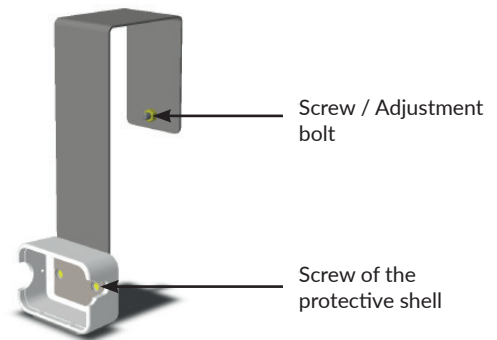

Caliper for protective shell
Part nr. 12716

The caliper is designed for the fixing of a protective shell of Nano SPY on cabinets with horizontal opening to facilitate cleaning operations. The caliper can be mounted on 65mm wide walls (without the screw + adjustment bolt). The protective shell of Nano SPY can be directly glued to the bottom of the bracket and/or fixed with screws (provided).